

# Roof, windshield/rear window frame

## Roof, alignment chart

**Obs!** The illustrations in this service information are used for different model years and/or models. Some variation may occur. However, the essential information in the illustrations is always correct.

### Dimensions



1

#### Explanation of dimensions

The dimensions in the table are listed as follows:

Symbol number 1 means that the measurement is taken from the center.

Symbol number 2 means that the measurement is taken from an edge.

- 1 
- 2 
- 3 

R8101811

2

Symbol number 3 means that the measurement is taken from a cut mark.

Measurements are taken from the bottom of the recess, see illustration.

If only one measuring point symbol is displayed, the symbol applies to both measuring points. Otherwise the symbols are shown on each side of the dimension in the illustration.



R8101890

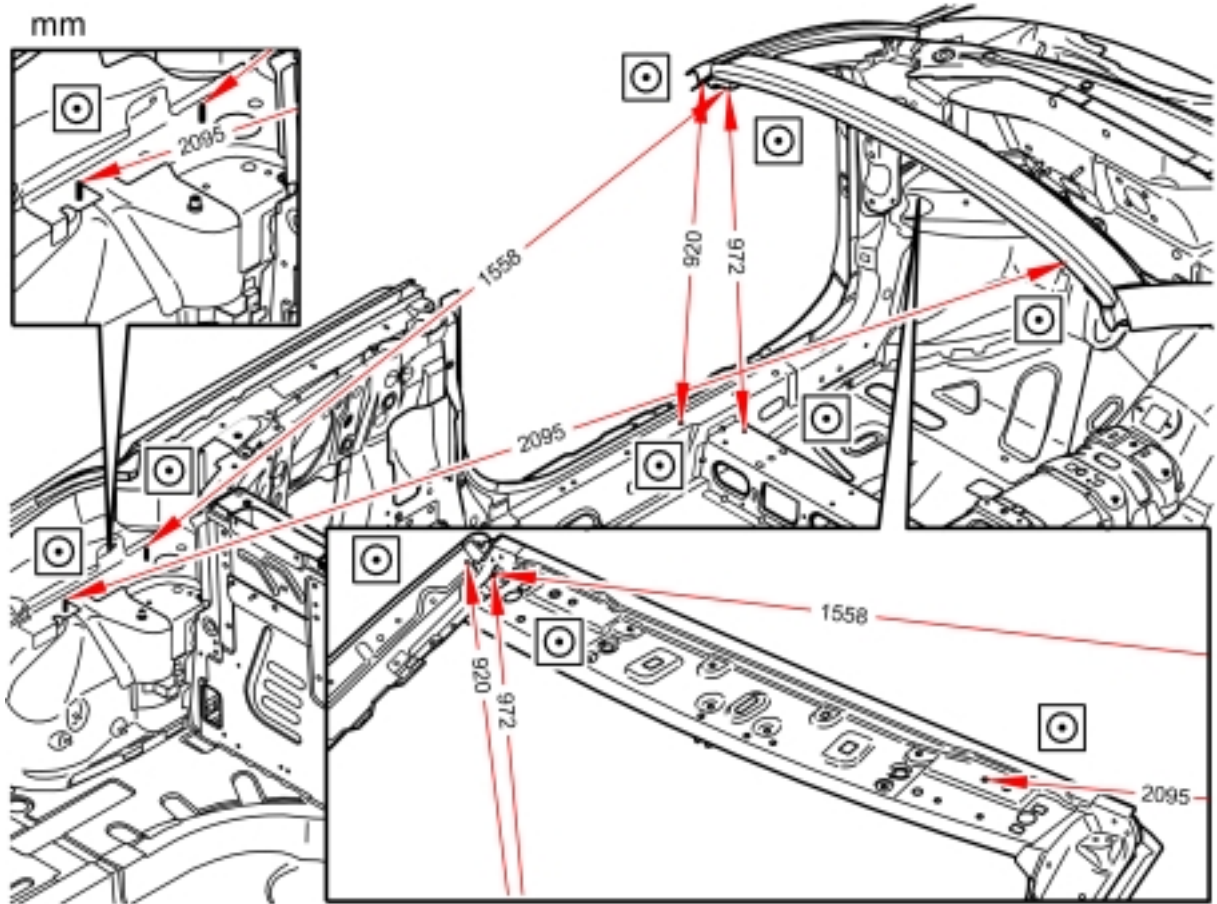

IMG-233465

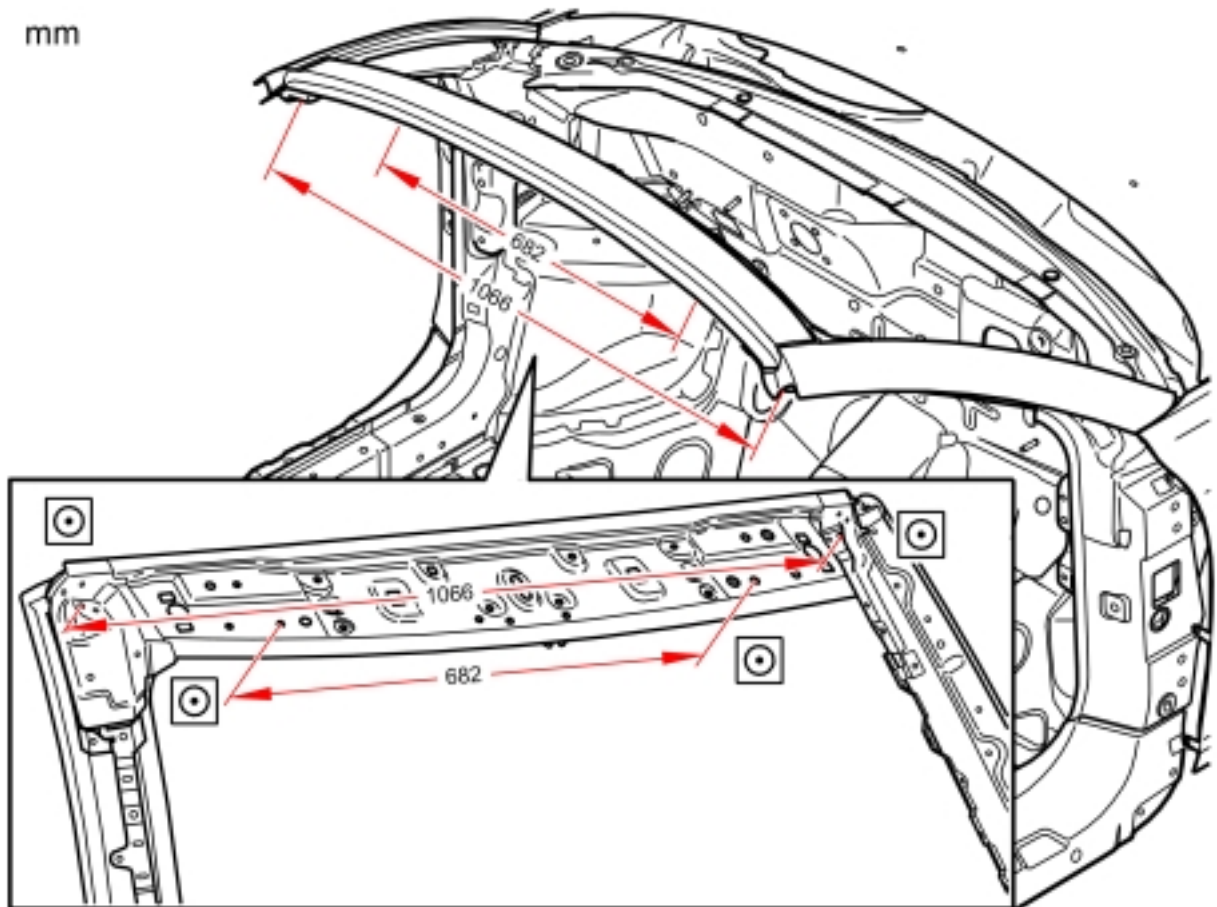

IMG-233467

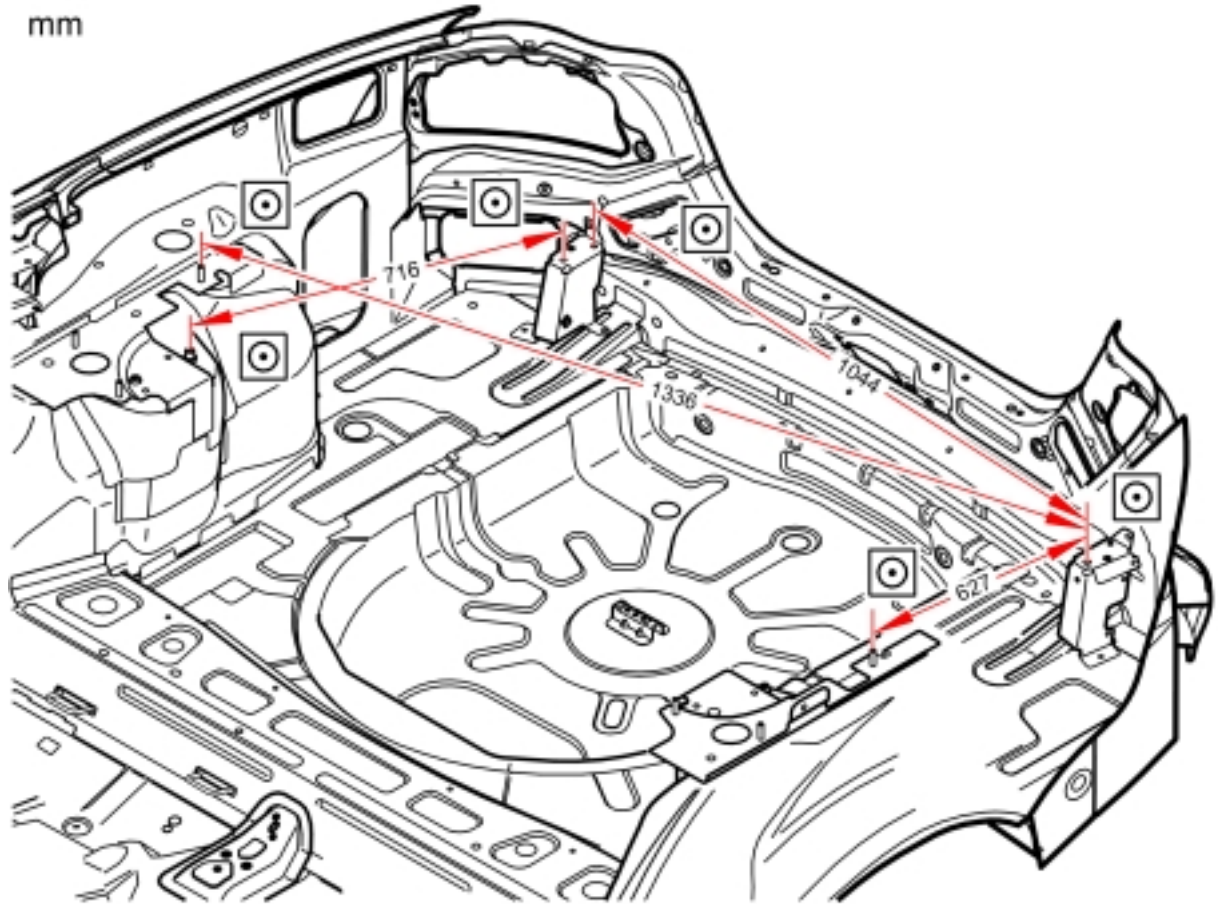

IMG-233468

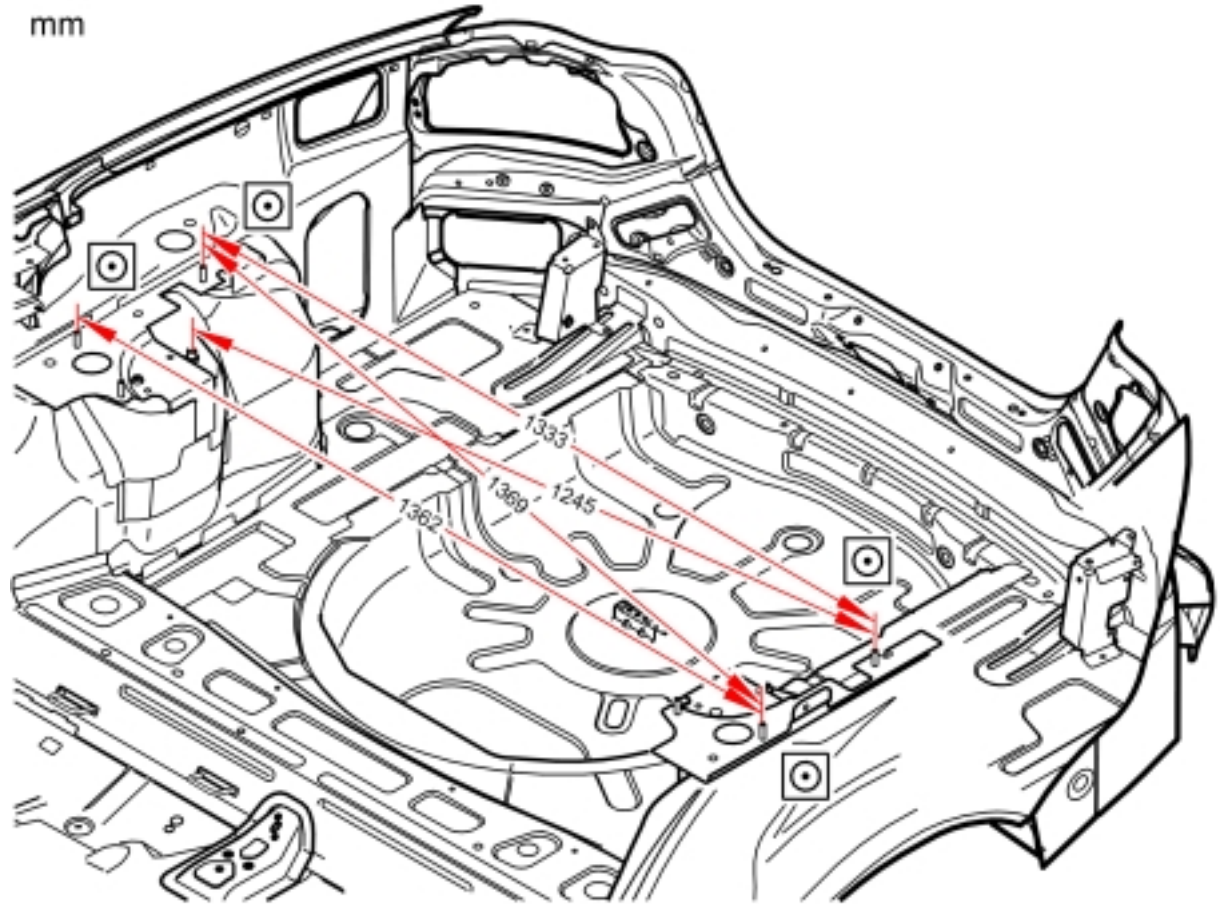

IMG-233469

mm

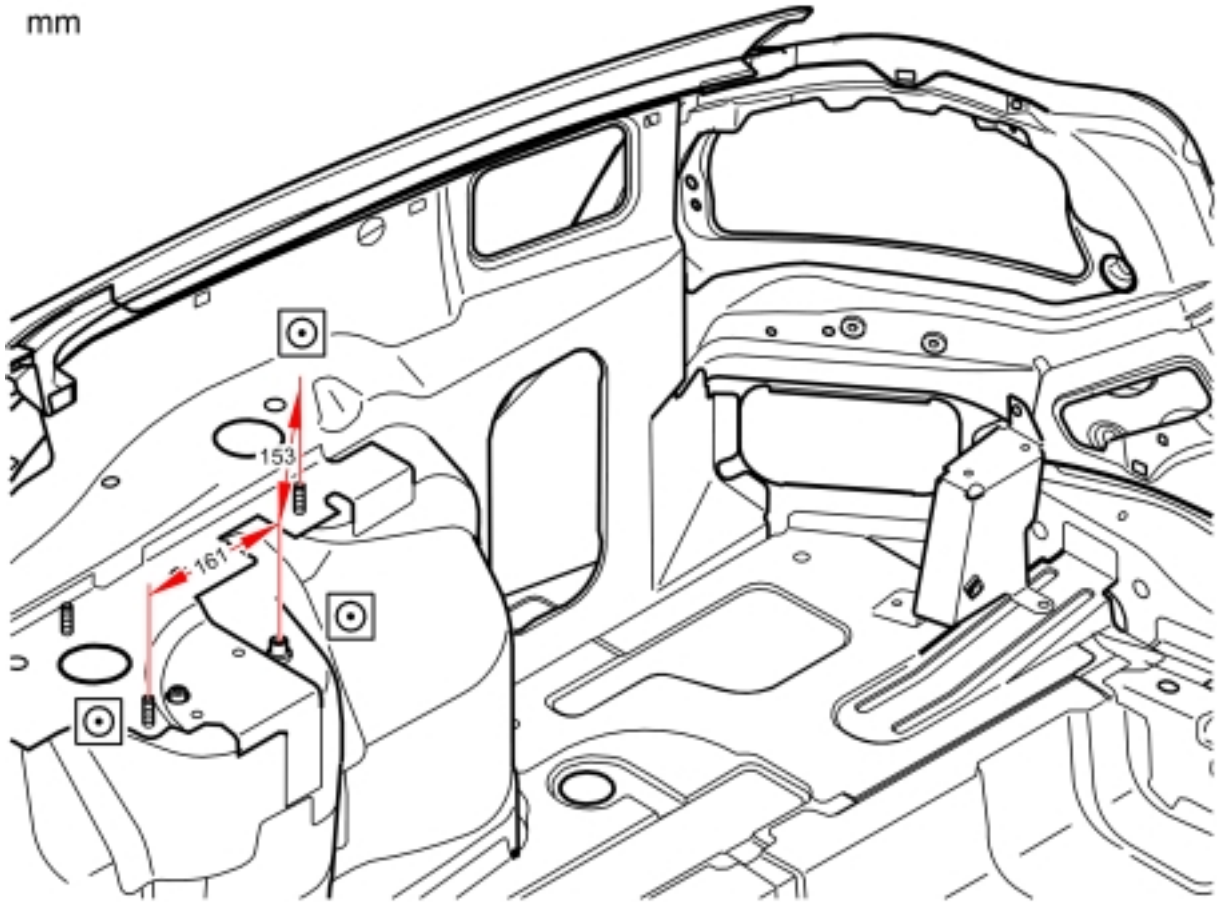

IMG-233470



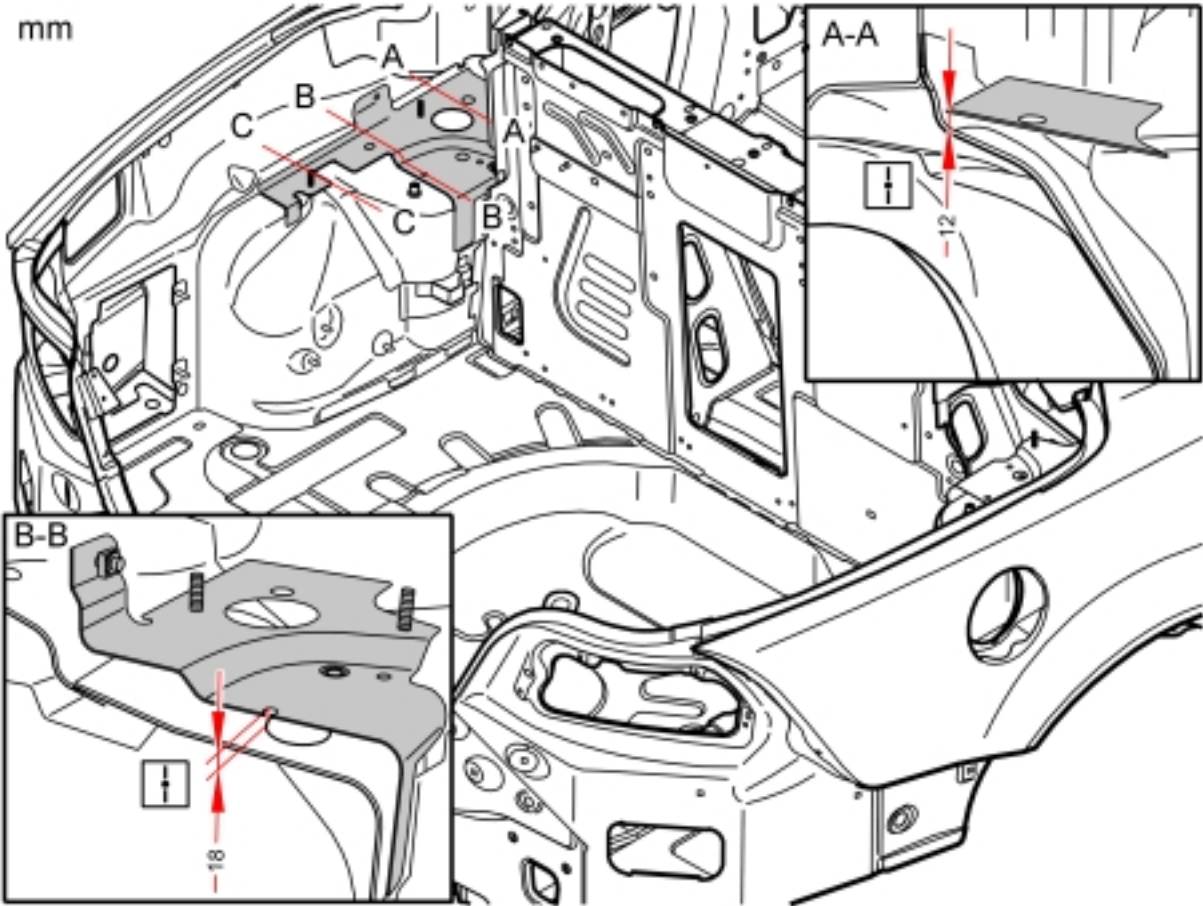

IMG-233480

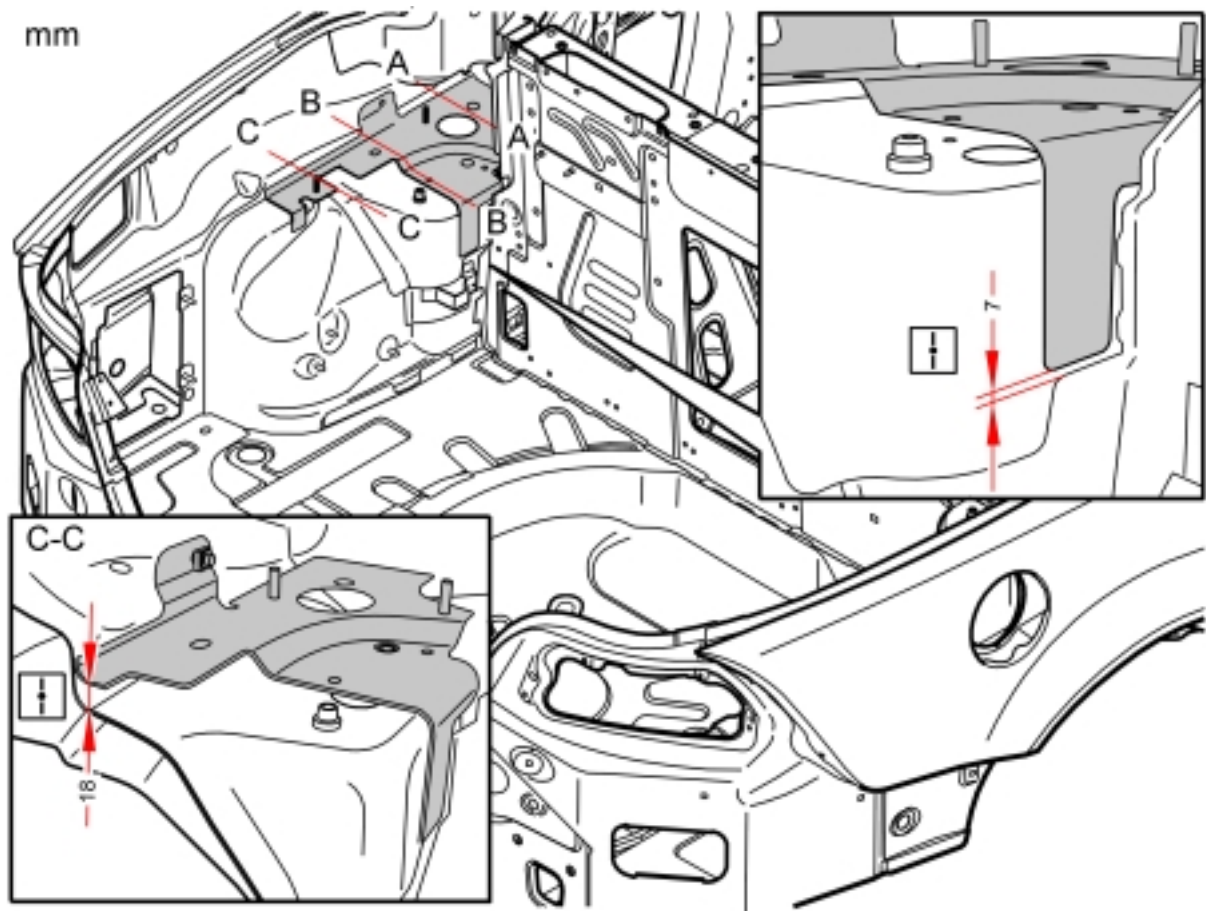

IMG-233481

Windscreen frame, alignment chart

**Obs!** The illustrations in this service information are used for different model years and/or models. Some variation may occur. However, the essential information in the illustrations is always correct.

Dimensions

1

Explanation of dimensions

The dimensions in the table are listed as follows:  
Symbol number 1 means that the measurement is taken from the center.  
Symbol number 2 means that the measurement is taken from an edge.

- 1
- 2
- 3





R8101890

Symbol number 3 means that the measurement is taken from a cut mark.

Measurements are taken from the bottom of the recess, see illustration.

If only one measuring point symbol is displayed, the symbol applies to both measuring points. Otherwise the symbols are shown on each side of the dimension in the illustration.

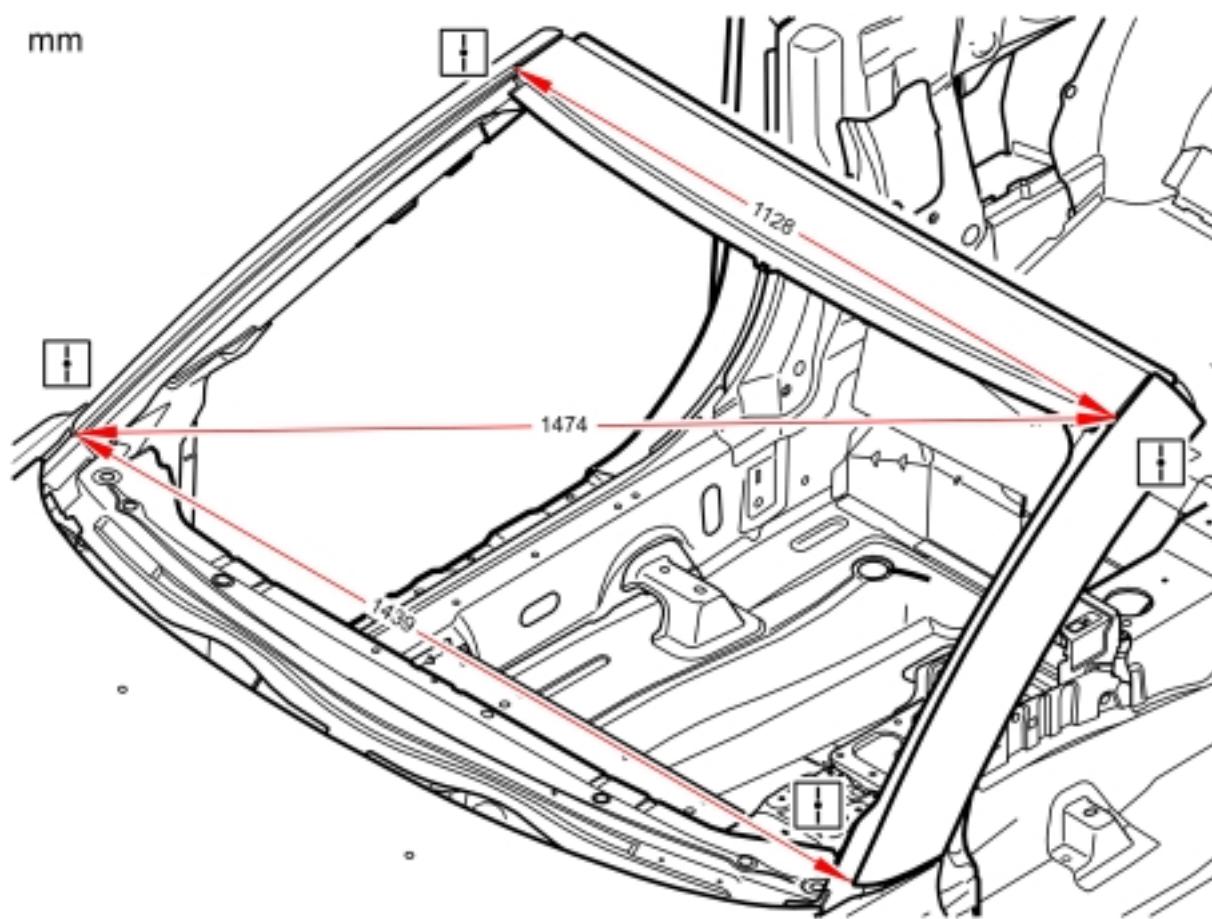

IMG-233320

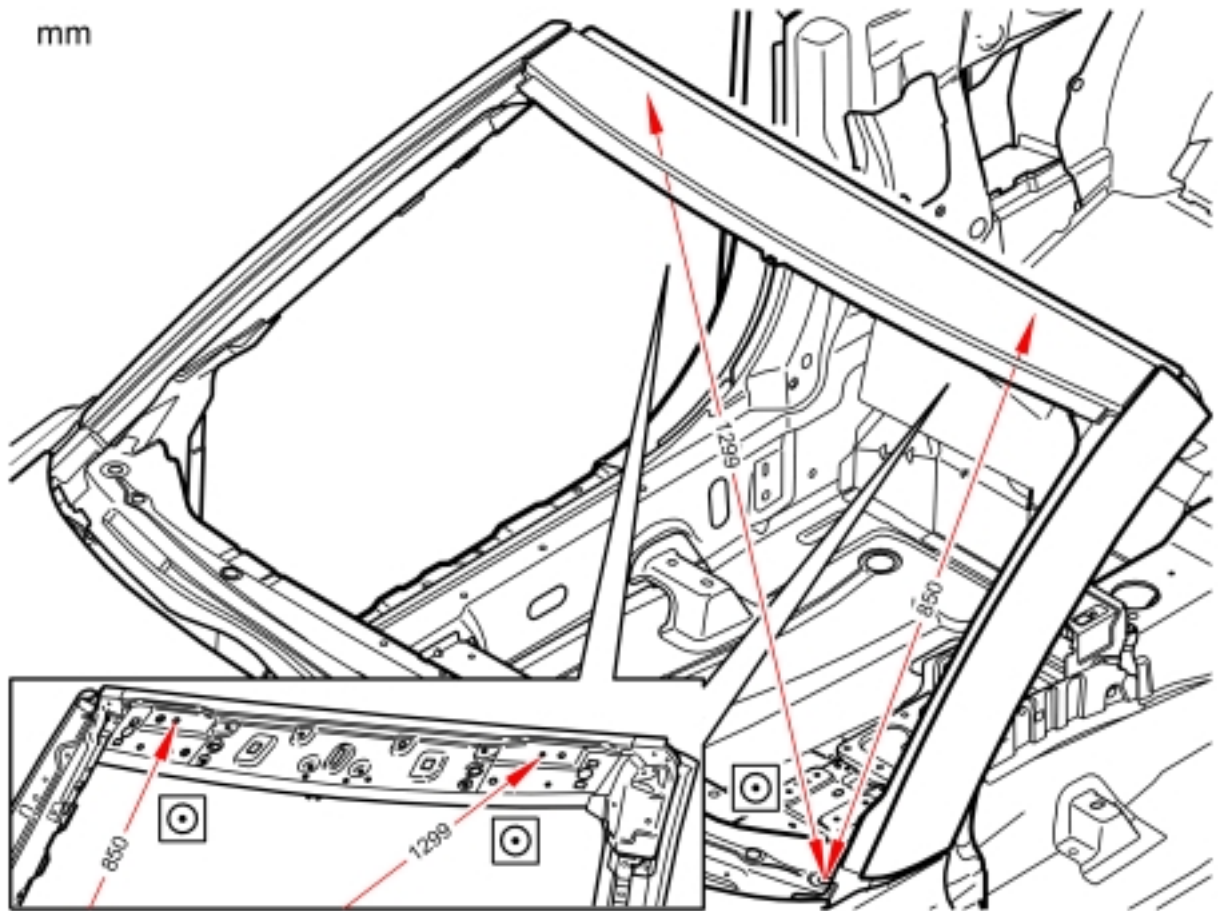

IMG-233321