

## Cargo compartment weatherstrip, replacing

**Obs!** The illustrations in this service information are used for different model years and/or models. Some variation may occur. However, the essential information in the illustrations is always correct.

### Removing

#### Removing seal strip

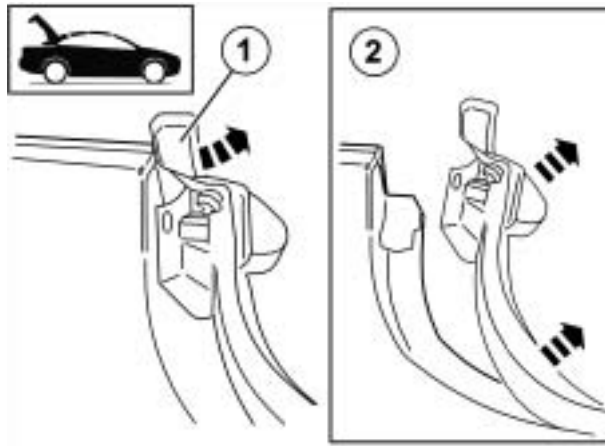

IMG-

235388

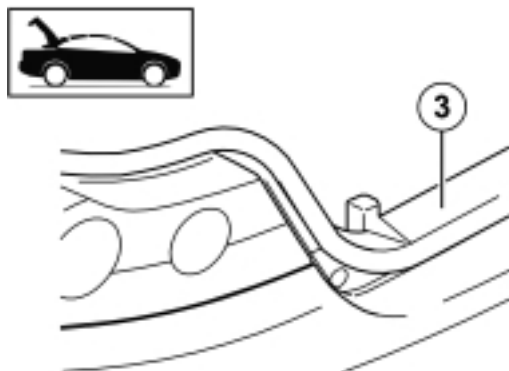

IMG-

235389

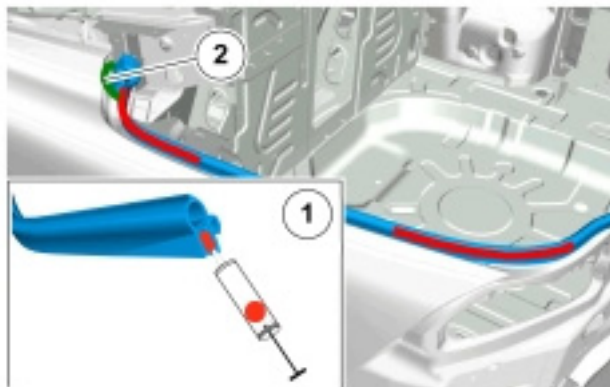

IMG-

235341

### Installing

#### Apply sealant:

- 1 part number 116 1235
- 2 part number 116 1782. Pull out the tape so that it becomes approx. 3 mm thick.

1

2

3

1

Install in the reverse order.