

Section	Group	Weight (Kg/Pounds)	Year	Month
8	891	21.5/47.4	2006	12

Towbar, detachable

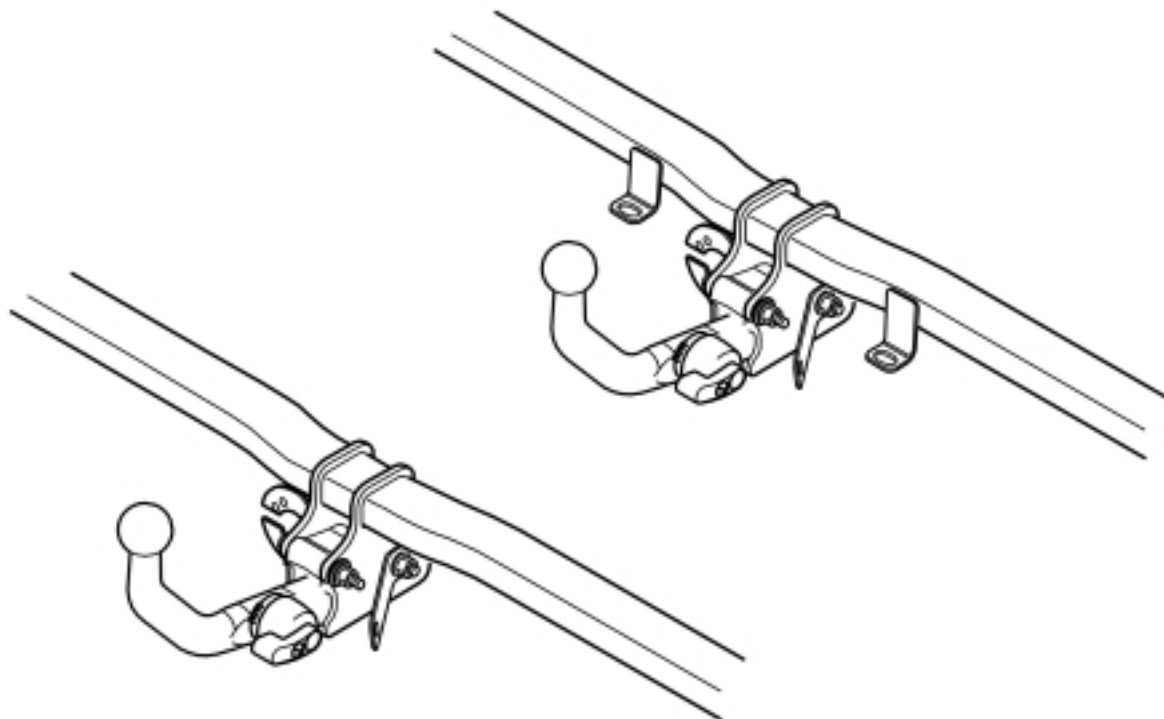

M8903718

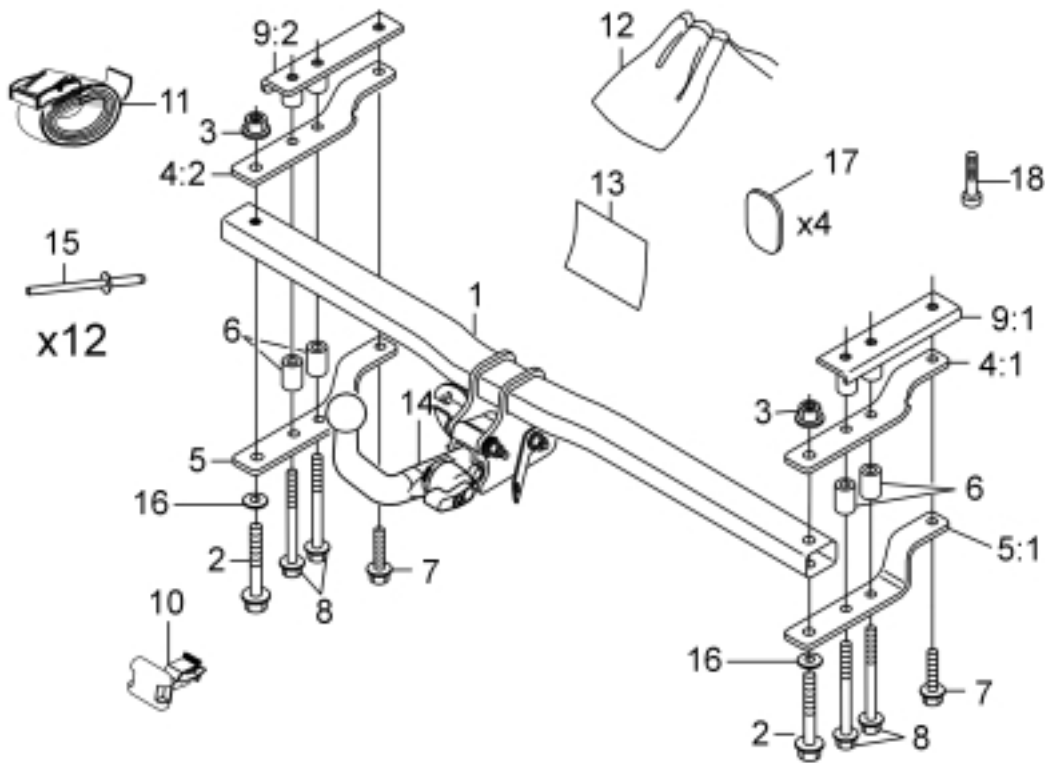

IMG-213340

Part no:	Kit no:	Supplier no:	Model	EU approval no:	D-value	Vert. load Kg (lbs)
31213723	31213724	60-146800	S	E11*94/20*4709*00	9.8 kN	85 kg
31213725	31213726	60-146900	S	E11*94/20*4710*00	10.3 kN	85 kg

IMG-262238

Any comments on this publication? Please contact your nearest retailer. Thank You!

Publ.no:	Issue:	Kit no:
Comments:.....		
.....		
.....		
.....		

From:	
Address:	
Telephone:	
Telefax:	

IMG-213320

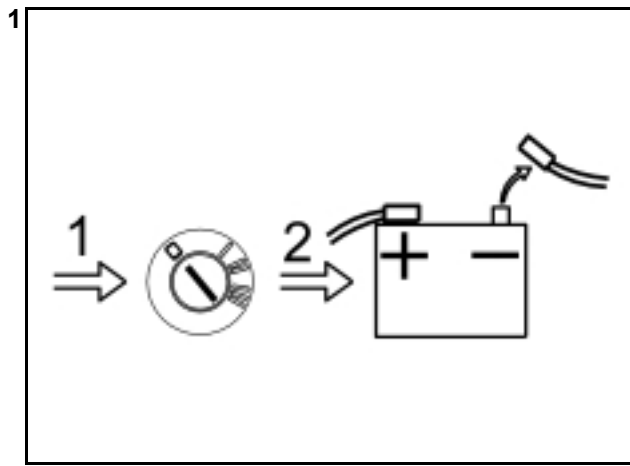

A8800136

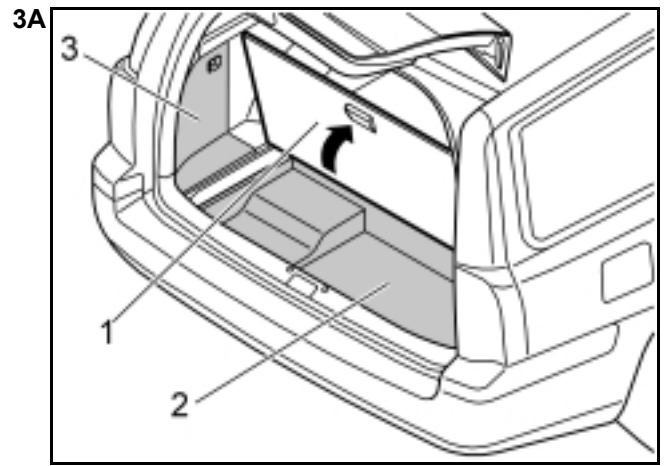

M8301410

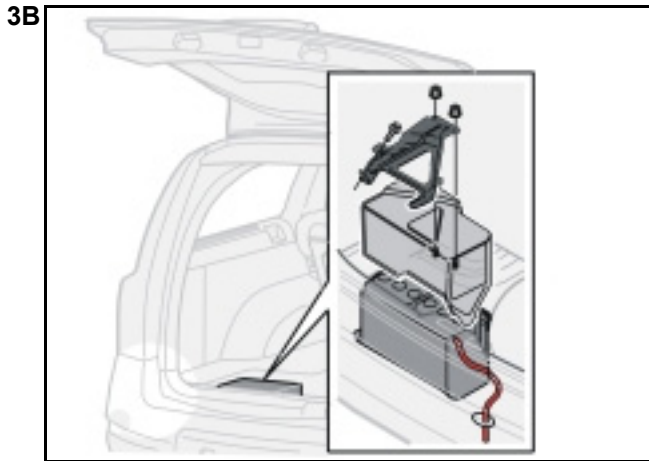

M3100090

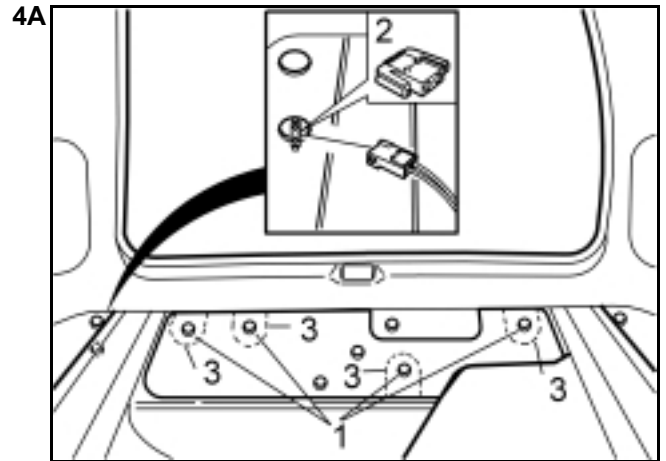

M8101064

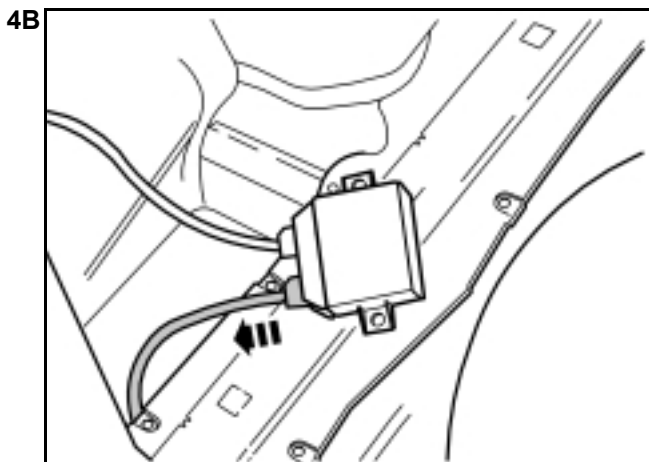

IMG-213364

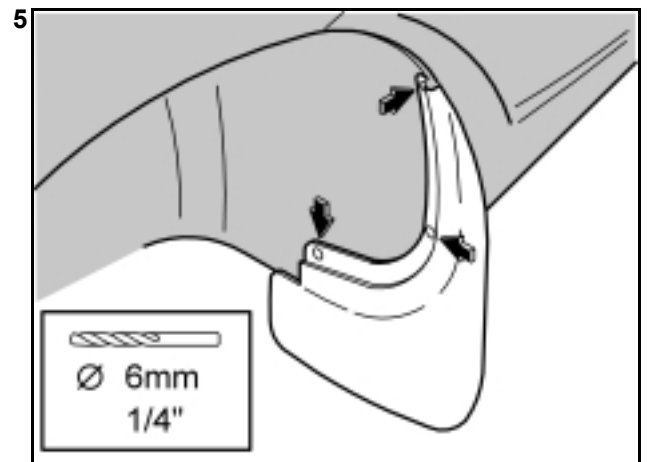

M8600564

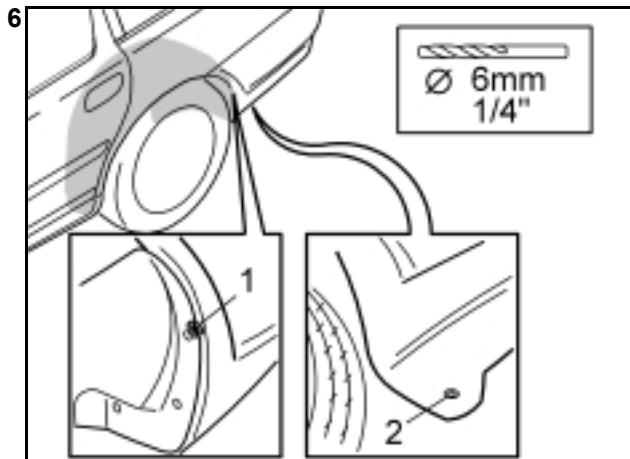

M8600565

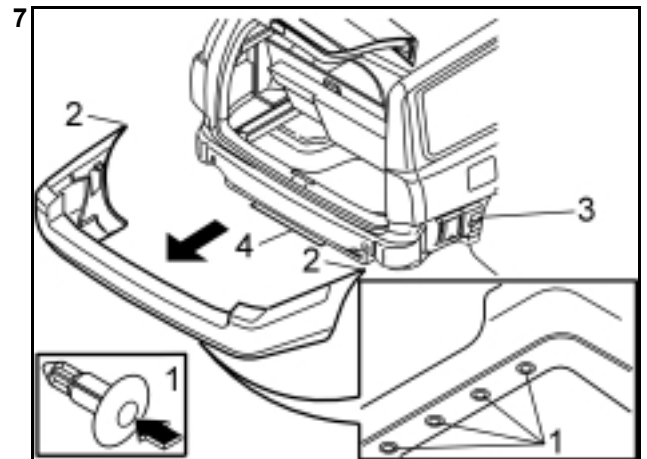

M8600494

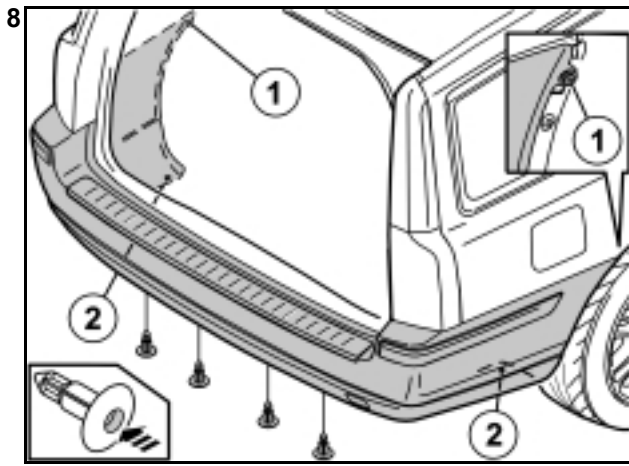

IMG-229822

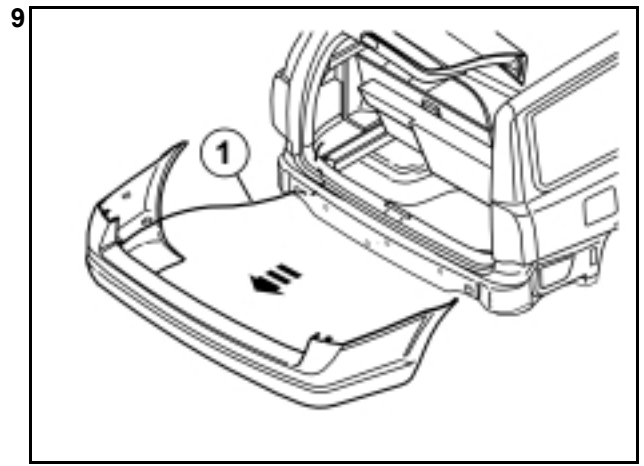

IMG-213367

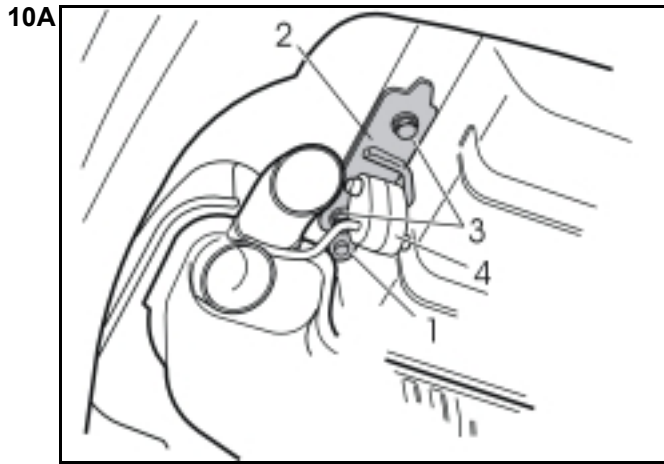

D2500722

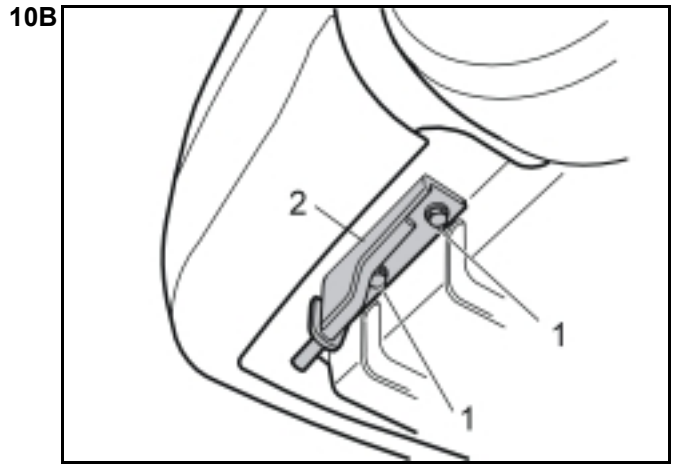

D8600247

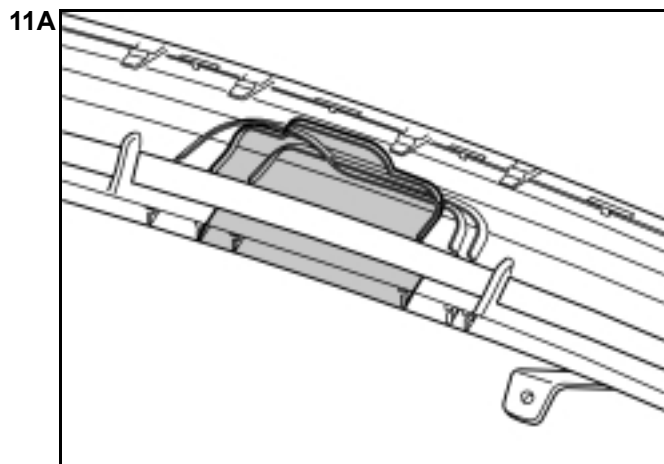

J8601270

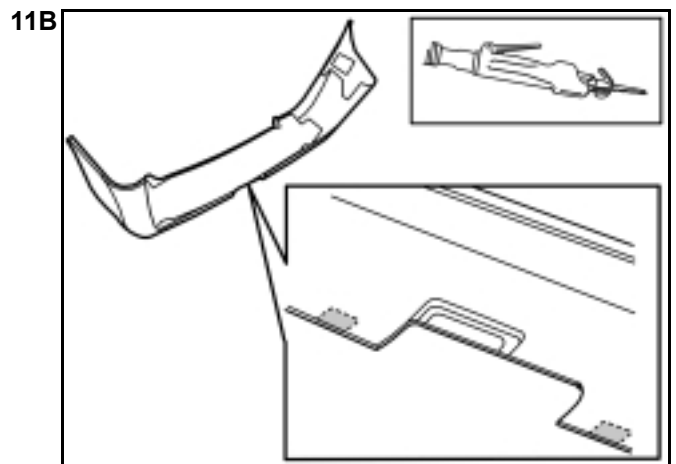

M8601281

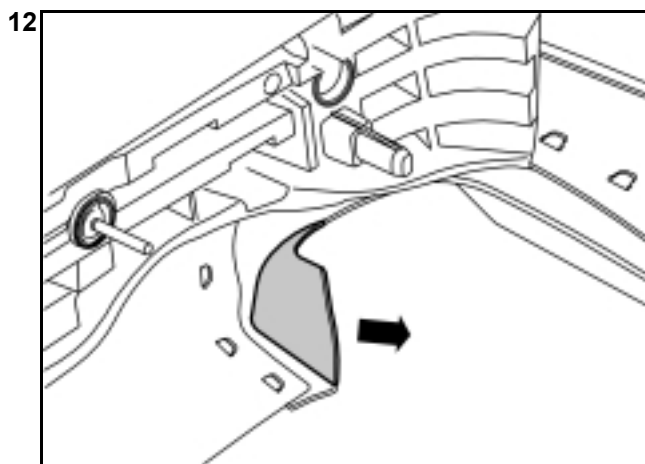

M8903417

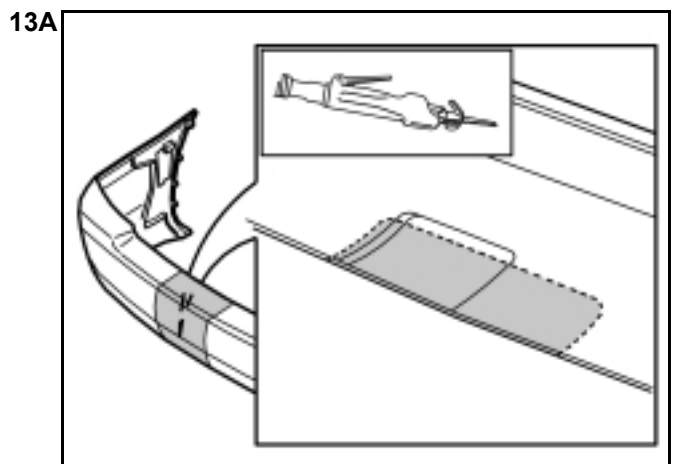

M8601259

13B

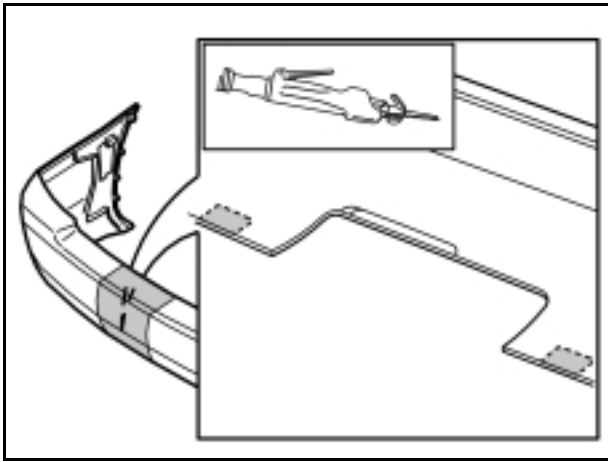

M8601280

14

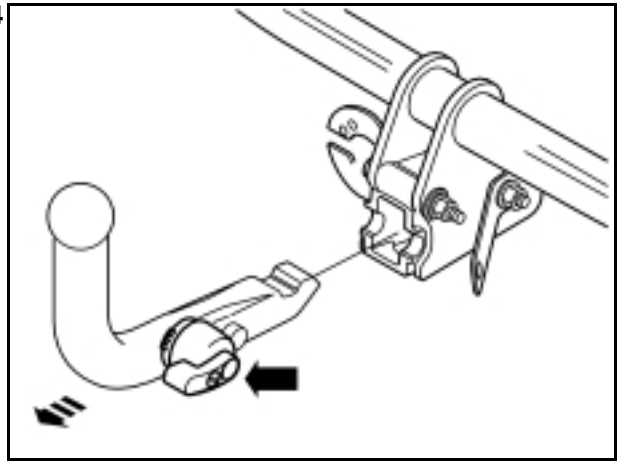

M8903711

15

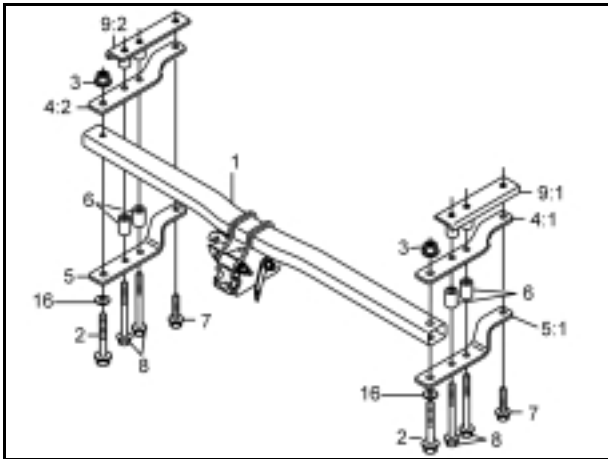

M8903705

16

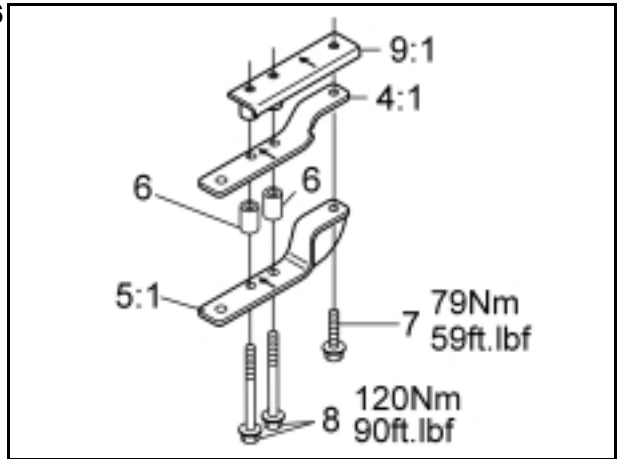

M8901566

17A

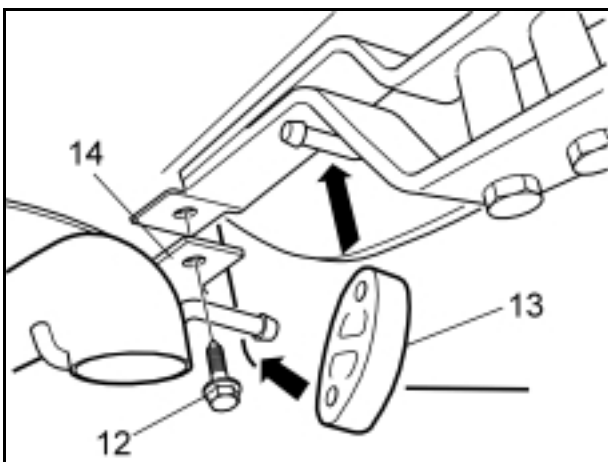

M8901484

17B

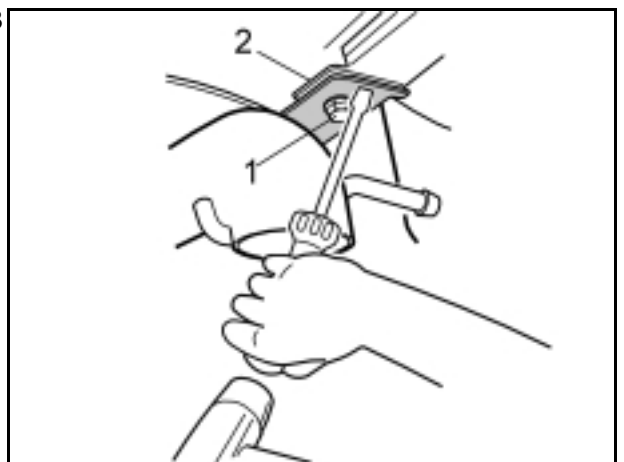

M8901566

18

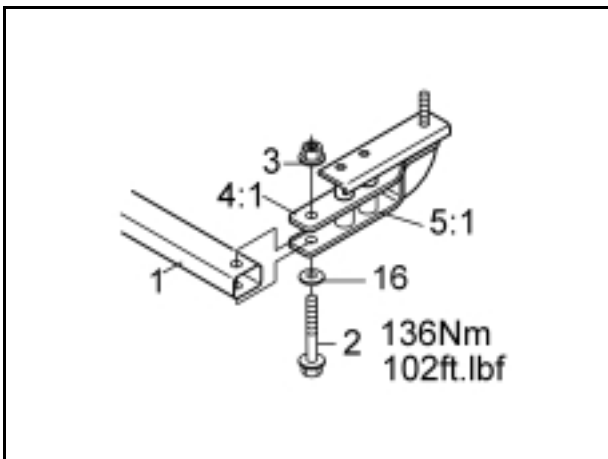

M8901567

19

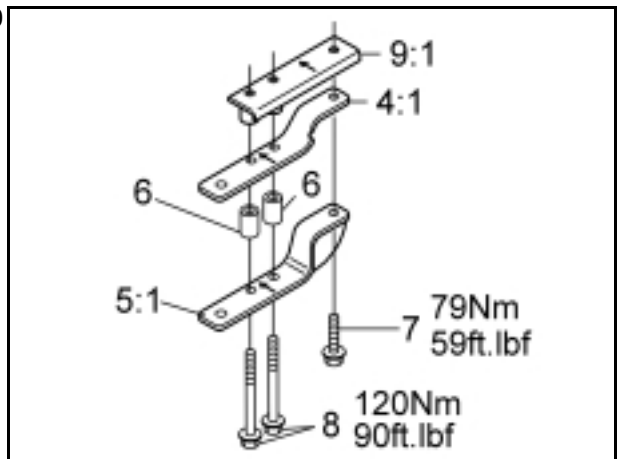

M8901566

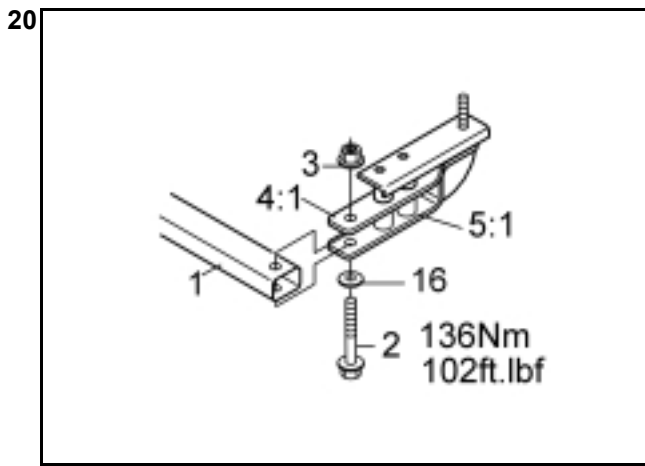

M8901567

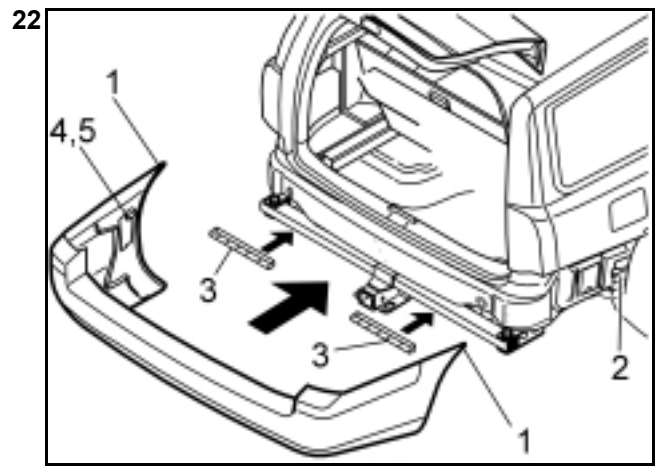

M8600867

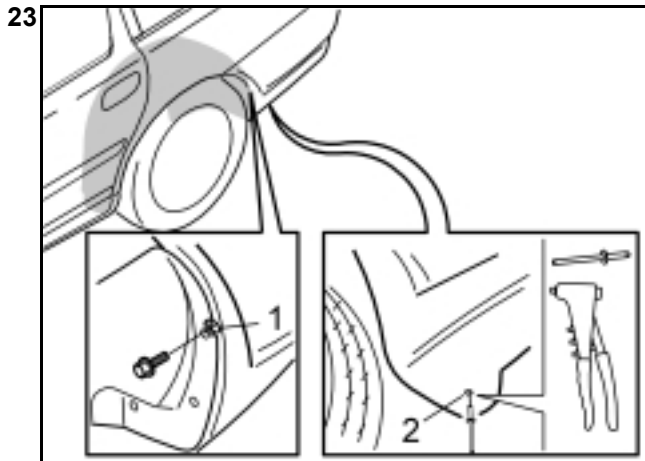

M8600569

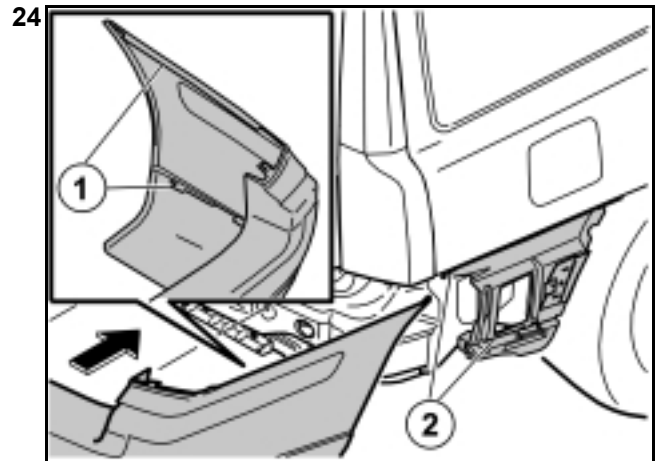

IMG-230001

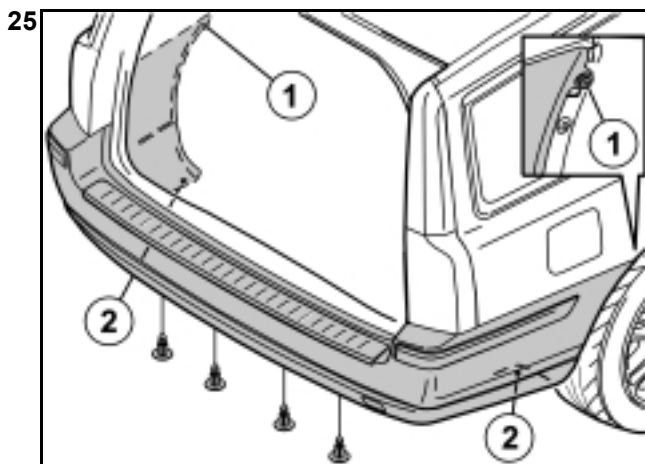

IMG-230002

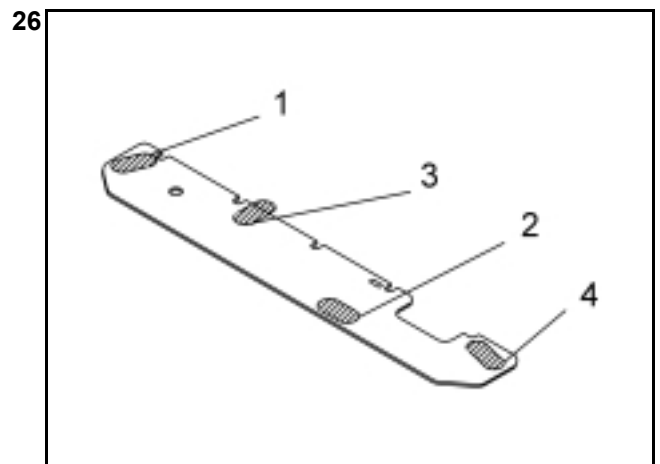

M8101296

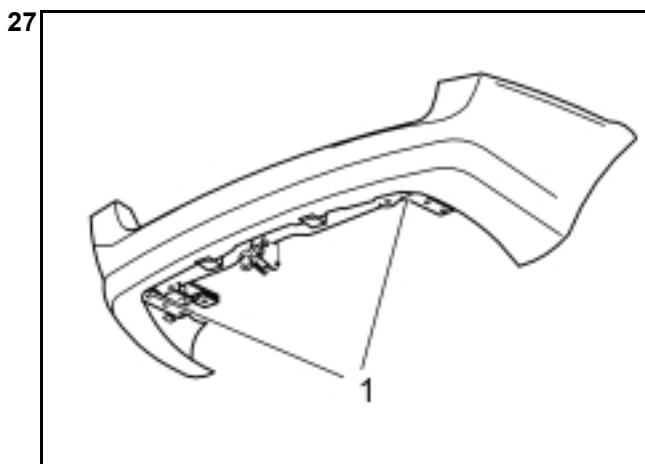

IMG-213440

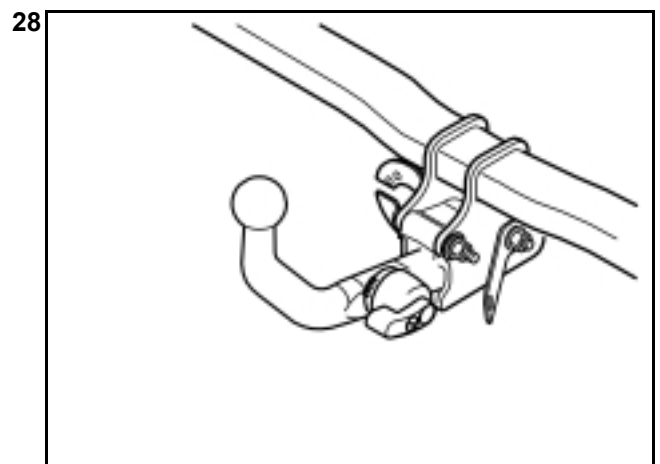

M8903707

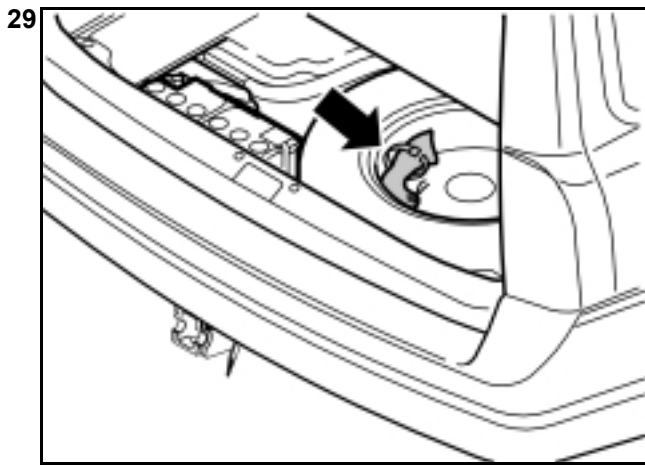

IMG-222587

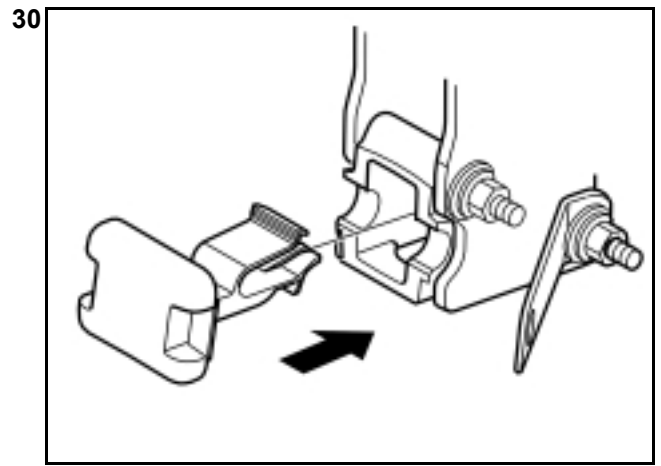

J8903520

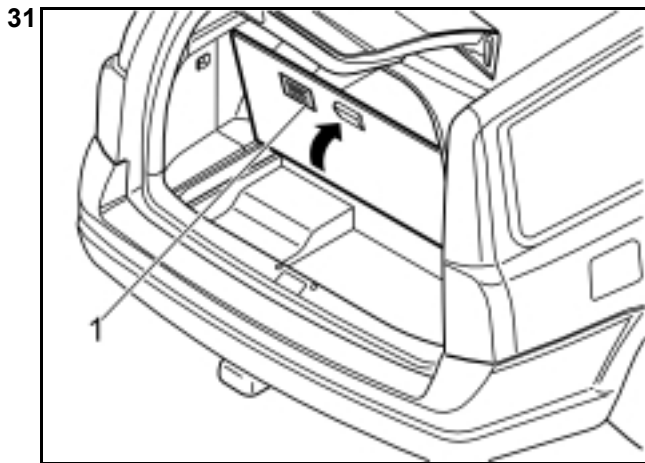

IMG-213442

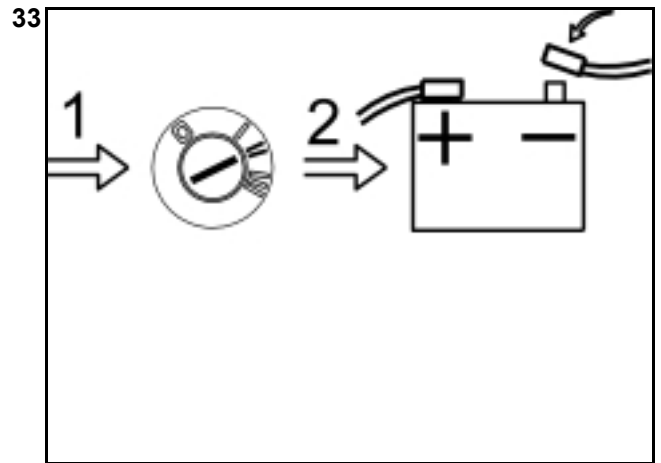

A8800137

English

INTRODUCTION

- **NOTE! Read through the entire text before carrying out any work.**
- The front page gives the date of this edition and the edition it replaces
- The second page shows the tools needed for the installation and the contents of the installation kit
- The illustrations display the procedure in order of operation. The order of operation is repeated in the text section
- Cut out the text page in order to follow the illustrations and text at the same time.

Towbar, detachable

NOTE! Kit contents:

- 1 Crossmember
- 2 Screw M14x80 (x2)
- 3 Nut M14 (x2)
- 4 Upper bracket (x2)
- 5 Lower bracket (x2)
- 6 Sleeve (x4)
- 7 Screw M12x50 (x2)
- 8 Screw M12x130 (x4)
- 9 Reinforcement panel with sleeves (x2)
- 10 Protective plug
- 11 Strap
- 12 Protective bag
- 13 Decal
- 14 Detachable towbar
- 15 Blind rivet (x12)
- 16 Washer (x2)
- 17 Rubber tab (x4)
- 18 Screw 4.8 X 9.5

Type approval of the towbar is in the table on the second page.

It is recommended that the work at steps 7, 8, 22 and 24 is carried out by two people.

- 1 – Turn the ignition key to position 0.
– Remove the ignition key.
NOTE! Wait at least five minutes before disassembling the connectors or removing other electrical equipment.
- 2 – Pre-install the cable harness connector for the towbar according to step 1 in the Installation Instructions for the appropriate cable harness.

3 Illustration A

- Lift up and remove the floor hatch (1).
- Lift up and remove the storage cover (2).
- Remove the side panel (3) on the left-hand side.

Illustration B

- Remove the holder for the cover over the battery by removing the two nuts from the front edge of the battery holder. Unscrew the screw in the rear edge a few turns. Remove the holder.
- Remove the battery cover.
- Disconnect the battery negative lead.
- Move or remove the battery to facilitate access.

4 Illustration A

- Remove the perforated sections (3) in the lining mat.
- Remove the nuts (1) in the rear crossmember. This allows the bumper to be removed.
- Separate the connector (2) for the antenna.

Illustration B

Applies to cars with parking assistance

- Detach the parking assistance module (PAM) from its location on the member on the left-hand side of the cargo compartment.
- Detach the smaller connector from the control module.

5 – Raise the car.

Applies to cars with rear mudflaps

- Remove the rear wheels.
- Carefully drill out the rivets holding the mudflap on both sides. Use a **Ø6 mm (1/4")** diameter drill bit.
- Remove the mudflaps.

6 Applies to cars up to and including model year –2004 (CH -458999)

- Carefully drill out the rivets (2) underneath the bumper on both sides. Use a **Ø 6 mm (1/4")** diameter drill bit.
- Remove the screw (1) holding the wheel arch liner for the bumper cover on both sides.
Do not damage any of the plastic components.

7 Applies to cars up to and including model year –2004 (CH -458999)

Check if the car has clips

- Remove the clips (1) underneath the bumper cover by pressing in the centre of the clip until a clicking sound is heard. Remove the clips. The clips shall be re-used.

Applies to all models

- Pull the bumper backwards slightly. Bend out the sides (2) so that they detach from the mounting (3). Then pull the bumper backwards until it detaches completely.
- Place the bumper on a clean underlying surface that will not damage the paint.

Applies if the car has moulding

- Carefully remove the moulding (4) from the expander screws.

8 Applies to cars from and including model year 2005 (CH459000-)

- Remove the screw (1) in the upper edge of the end face on both sides.
- Remove the screw (2) in the lower edge of the wheel arch on both sides.
- Push in the centre of the four clips on the underside of the bumper cover. Remove the four clips by pulling them through the holes.
- Place the bumper on a clean underlying surface that will not damage the paint.

9 Applies to cars with parking assistance

- Detach the bumper in accordance with the above. Carefully pull the cable (1) out through the hole in the car.

10 Illustration A

- Remove the rivet (1) on the bracket (2) for the silencer. Use cutting nippers.
- Remove the screws (3) on the bracket.
- Remove the rubber mountings (4). Remove the bracket. The bracket will not be used again.

Illustration B

- Remove the screws (1). Remove the bracket (2). The bracket shall not be re-used.

11 Illustration A

Applies to V70, V70R from and including model year 2005– (CH 459000–), Europe and Australia

- Cut along the markings on the inside of the bumper to make the cut-out for the towbar. Cut out so that the marking lines remain in the bumper afterwards.

Illustration B

Applies to the Australian towbar with chain mountings.

- Install masking tape opposite the smaller cutting lines (2).
- Drill a hole inside each marking for the blade of the jig saw.
- Cut the material out inside the marking lines.
- After cutting, smooth off the edges using a file.

12 Applies to V70R up to and including model year –2004 (CH -458999)

- Apply masking tape on the outside of the exhaust pipe clip to avoid damage from the base of the saw. Leave the masking tape in place during installation.
- Cut along the marked raised area and remove the cut-out area.

13 Illustration A

Applies to cars up to and including model year –2004 (CH -458999)

- Use the cutting template from the kit to pre-mark the cutting lines on the inside of the bumper. Position the cutting template as illustrated.
- Carefully mark out the cutting lines around the cutting template.
- Cut along the markings on the inside of the bumper to make the cut-out for the towbar. Cut out so that the marking lines remain in the bumper afterwards.

Illustration B

Applies to the Australian towbar with chain mountings.

- Use the smaller cutting templates from the kit to pre-mark the cutting lines on the inside of the bumper. Position the cutting template as illustrated.
- Install masking tape opposite the smaller cutting lines.
- Drill a hole inside each marking for the blade of the jig saw.
- Cut the material out inside the marking lines.
- After cutting, smooth off the edges using a file.

- 14** – Remove the towbar by pressing in the lock knob and turning it down until a click is heard.
- Turn the lock knob down further, right to when it stops, hold the lock knob down and pull out the ball section.

- 15** – Clean away any underseal and dirt from the surfaces between the towbar and the bodywork.

The illustration shows how the towbar and its components are assembled and installed on the body.

- 16** – Install the screws (7, 8) from underneath the brackets (4:1, 5:1, 9:1), including the sleeves (6). Tighten by hand. The arrows on the brackets (4:1, 5:1, 9:1) must point in towards the centre of the car. Carry out on both sides, the right-hand side is illustrated.

17 Illustration A

Illustration B

Carry out in accordance with illustration A and B

- Install the heat deflector plate (14) using the screw (12).
 - Loosely screw the heat deflector plate into place on the member (2) using the screw (1).
 - Bend the heat deflector plate using a screwdriver.
 - Fully screw in the screw.
 - Reinstall the rubber mounting (13) for the silencer. Use normal soap to facilitate installation.
- 18** – Insert the member (1) between the brackets (4, 5) and centre around the holes.
- Install the screws (2) and washers (16) from underneath the bracket (5) and the nuts (3) from above, without tightening.
- 19** – Tighten the screws (7) to **79 Nm (58 lbf.ft.)**.
- Tighten the screws (8) to **120 Nm (89 lbf.ft.)**.
 - Carry out on both sides, the right-hand side is illustrated.
- 20** – Tighten the screws (2) and nut (3) to **136 Nm (100 lbf.ft.)**.
- Wait for at least five minutes so that the joint has time to set. Then tighten the screws (8) on both sides, a quarter turn (angle tightening 90°).
- NOTE! Torque tightened screws that have been removed must not be re-used.**

- 21** – Underseal.

Applies to Sweden only

- Underseal after the state roadworthiness inspection.

22 Applies to cars up to and including model year –2004 (CH -458999)

- **Applies if the car has moulding:** Reinstall the mouldings (3) on the expander screws and press them in.
- If the guide lugs (4) and clips (5) have loosened – reinstall them.
- **Applies to cars with parking assistance:** Lift up the bumper in position. Pull the cable for the sensors through the hole for the bumper's guide, and pull the cable in from the inside.
- Reinstall the bumper by pressing it forwards. Ensure that the four screws, protruding from the bumper, align with the holes in the car.
- Before the bumper is completely installed, slide the top edge (1) into the grooves. Then slide the bumper fully in.
- Check that the guide lug (4) and clip (5) are centred with the hole (2) in the wheel arch liner.

23 Applies to cars up to and including model year –2004 (CH -458999)

- Tighten the screw (1) on both sides.
- Rivet (2) the bumper into place as illustrated.
- Reinstall the nuts. Tighten the nuts. Tighten to **18 Nm (13 lbf.ft.)**.
- Connect the antenna connector.

Applies to cars with rear mudflaps

- Rivet in the mudflap.
- Reinstall the wheels and tighten the screws alternately to **110 Nm (81 lbf.ft.)**.

24 Applies to cars from and including model year 2005- (CH459000-)

- **Applies to cars with parking assistance:** Lift up the bumper in position. Pull the cable for the sensors through the hole for the bumper's guide, and pull the cable in from the inside.
- Guide the hooks (1) for the bumper into the guides (2) in the side brackets. Press at the upper edge and in the middle so that the hooks engage.

25 Applies to cars from and including model year 2005- (CH459000-)

- Install the screw (1) in the upper edge of the end face on both sides.
- Install the screw (2) in the lower edge of the wheel arch on both sides.
- Install the four clips.

Applies to cars with rear mudflaps

- Rivet in the mudflap.
- Reinstall the wheels and tighten the screws alternately to **110 Nm (81 lbf.ft.)**.

26 Install the rubber tabs from the kit over the four installed screws as follows:

- Align the rubber tabs (1) edge to edge with the lining mat.
- Compress the rubber tab (2) slightly to align in the cut-out.
- Align the rubber tab (3) so that the lower edge is positioned edge to edge with the lining mat. Then cut off the section protruding from the lining mat. Do not remove too much.

- 27** – If necessary, cut away the area (1) around the screw heads, so that the screws are accessible.

- 28** – Check the function of the detachable towbar.

- 29** – Remove the towbar and place it in the protective bag.
- Place the towbar in the spare tyre as illustrated.
 - Thread the strap through the two nearest holes in the wheel and route the strap around the towbar.
 - Insert the strap into the tensioner. Tighten the strap until the towbar is secured and stable.

- 30** – Take the protective cover from the kit.
- Install it into the hole where the towbar shall be located and press it in.

- 31** – Install the enclosed decal (1) on the underside of the floor hatch. Staples can be used for more secure fitting.

- 32** – Install the cable harness for the towbar according to the appropriate Installation Instructions.

- 33** – **Applies to cars with parking assistance:** Connect the detached cable to the parking assistance module. Reinstall the control module.
- Turn the ignition key to position II.

Reinstall:

- The battery negative lead
- The battery cover and holder
- The side panel
- The storage cover and the floor hatch.

- 34** – Remove the masking tape from the bumper.