

Section	Group	Weight (Kg/Pounds)	Year	Month
8	89		2003	02

Bicycle holder, roof mounted

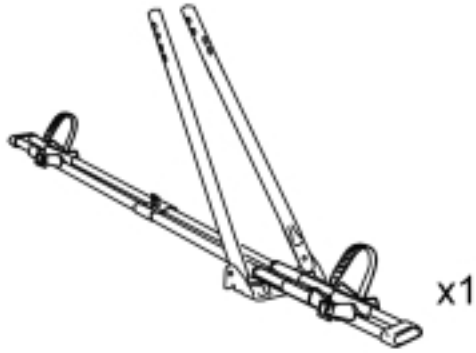

A0000162



x1



x1



x1



x1



x1



x1



x1



x2



x2



x1



x1



x6



x3

J8903383

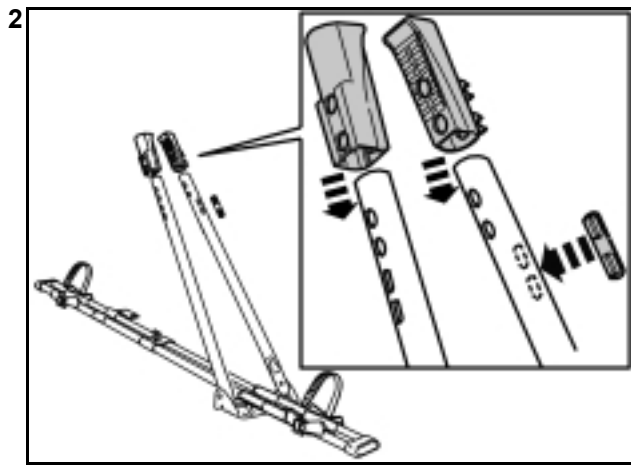

J8903372

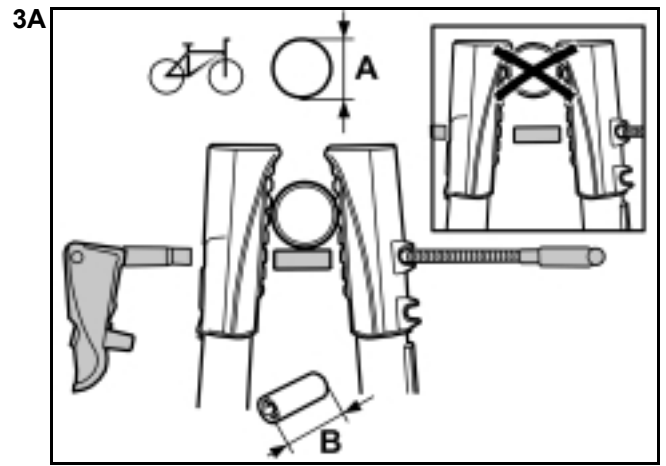

J8903379

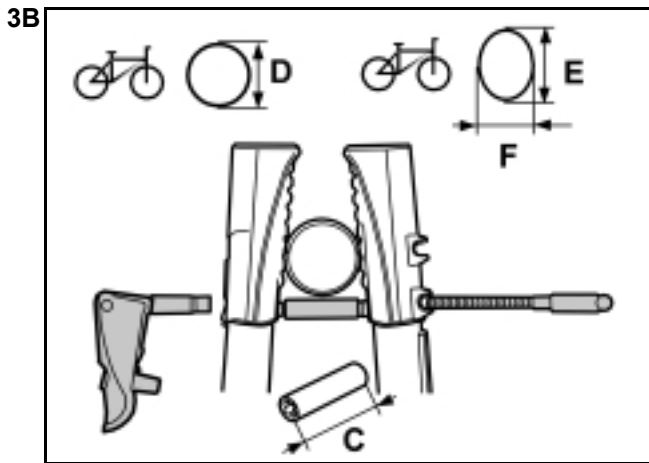

J8903381

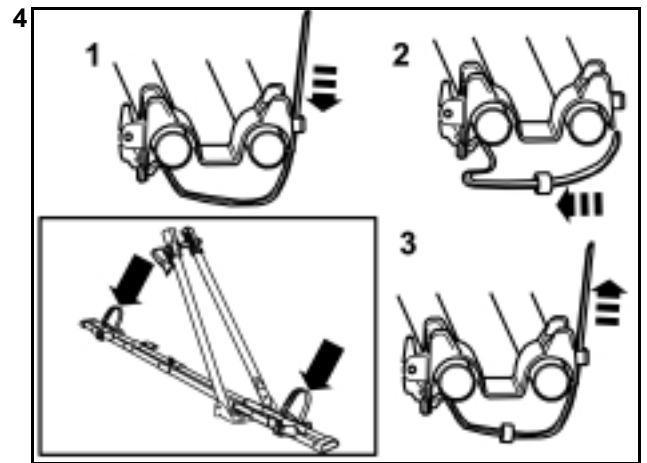

J8903374

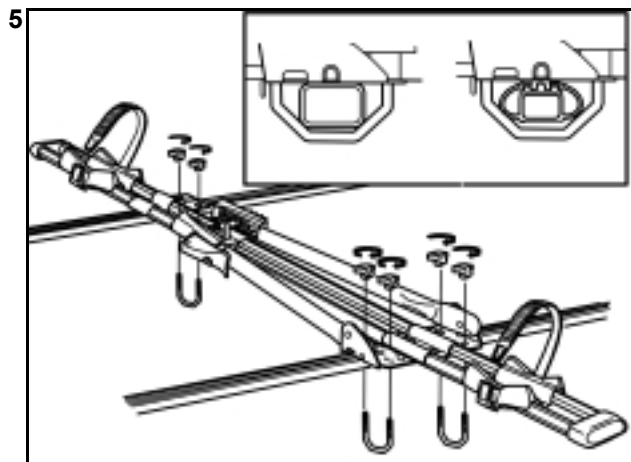

J8903378

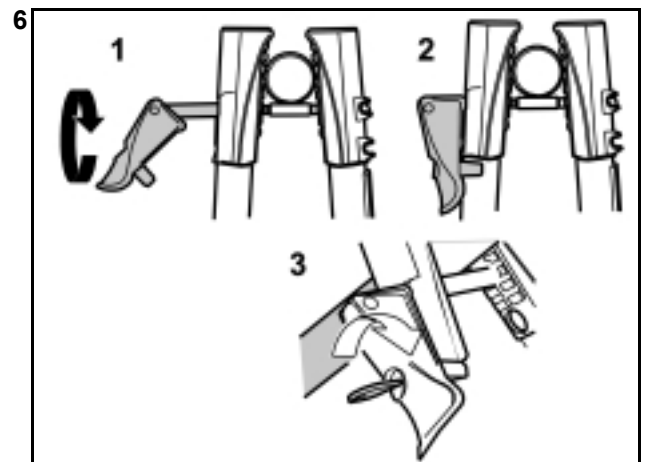

J8903375

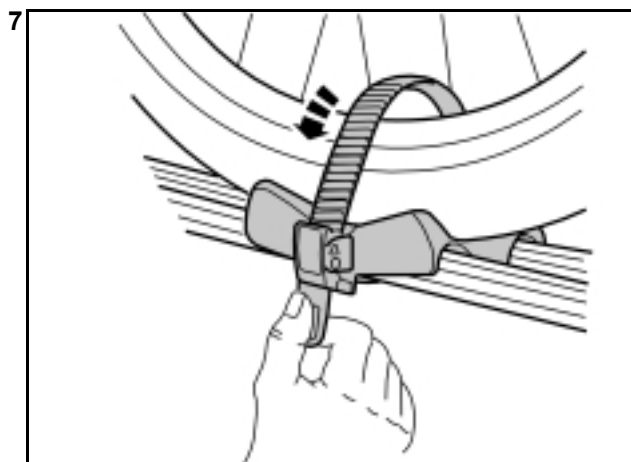

J8903382

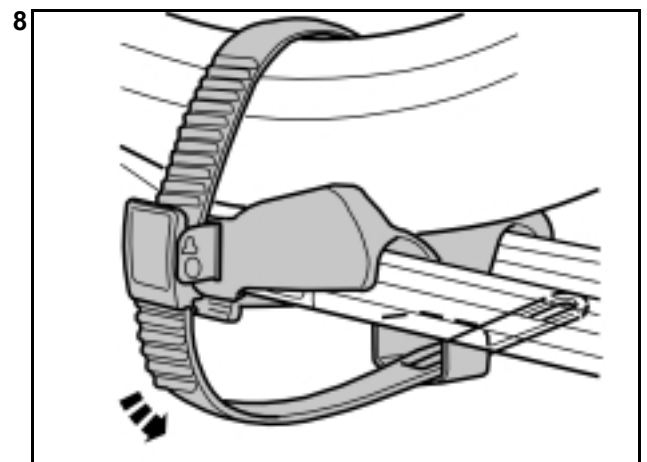

J8903371

English

INTRODUCTION

- **NOTE! Read through the entire text before carrying out any work.**
- The front page gives the date of this edition and the edition it replaces
- The second page shows the tools needed for the installation and the contents of the installation kit
- The illustrations display the procedure in order of operation. The order of operation is repeated in the text section
- Cut out the text page in order to follow the illustrations and text at the same time.

Bicycle holder, roof mounted

NOTE!

Important:

- Regularly check that the load carriers are properly secured
- Regularly check that the bicycle and bicycle holder are properly secured
- Handling is affected by the actual load and its position. The centre of gravity of the car changes when driving with a load, which affects the handling of the car. Adjust your speed accordingly
- The load increases the total height of the car which affects accessibility. Be aware of low roofs and entrances.

- 1 – Install the load carriers according to the separate Installation Instructions. If there are no set positions for the load carriers, they should be positioned approximately **800 mm (32")** apart
 - **Applies to cars with rails:** Position the load carriers so that there is no risk of the tailgate catching the bicycle holder when it is opened.

Assembling the bicycle holder

- 2 – Install the frame holders (from the kit) on the tubes. Ensure that the frame holders are on the correct side for bicycle holders mounted on the left or right-hand sides. This is to ensure that the lock can be reached
 - Cover the holes using the rubber blind cover plugs from the kit.

NOTE! Do not cover the holes where the latch will be positioned.

- 3 – Measure the diameter of the bicycle frame to determine which installation version applies for the bicycle.

Illustration A

Frame diameter (A): 22 - 58 mm (0.87" - 2.28")

- Install the frame holder screw (from the kit) in the upper hole in the frame holder
- Take the short frame protection (B) from the kit. Thread the frame protection onto the screw
- Screw the latch (from the kit) on to the frame holder screw
- Secure the frame holder screw in its cut out.

Illustration B

Frame diameter (D): 59 - 70 mm (2.32" - 2.75") and Oval frame (E, F): max 65 x 80 mm (2.56" x 3.15")

- Install the frame holder screw (from the kit) in the lower hole in the frame holder
- Take the long frame protection (C) from the kit. Thread the frame protection onto the screw
- Screw the latch (from the kit) onto the frame holder screw
- Secure the frame holder screw in its cut out.

- 4 – Ensure that the tensioner straps are on the correct side for bicycle holders mounted on the left or right-hand sides. This is done by turning the entire bicycle holder. Thread the rubber straps (from the kit) onto the tensioner straps, as illustrated.

Installing the bicycle holder on the load carriers

- 5 – Take mounting strips, U-shaped screws and knobs from the kit. Install the bicycle holder on the load carriers, as illustrated. Tighten to **3 Nm (2.2 lbf. ft.)**.

Securing bicycles

- 6 – Position the bicycle on the bicycle holder
 - Squeeze the frame holders together around the frame. Tighten the frame holders using the lock handle
 - Secure with the lock handle and engage the lock.

NOTE! Always ensure that the lock handle is locked during transit to prevent the bicycle from shaking loose.

- 7 – Secure the wheels with the tensioner straps. Ensure that the bicycle is stable.

WARNING! The bicycle can shake loose if it is not properly secured!

- 8** – Thread any excess tensioner strap into the rubber straps that were installed earlier. This holds the straps in place and prevents them rubbing against or hitting the roof of the car.

NOTE!

- Check that the bicycle and bicycle holder are properly secured
- Check again after driving a short distance
- Repeat the check at suitable intervals
- Tighten the tensioning straps and frame holders if necessary.